

# Standardverschraubungen

Messing

Arbeitsdruck max.	25 bar
Betriebstemperatur max.	150 °C
Material	Messing CW614N

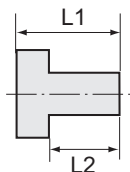

## Reduziernippel

Messing

**PLUS** ||



MS251K1418

### Reduziernippel, kurze Ausführung, zylindrisch

Artikel Nr.	Typen Nr.	Außengewinde	Innengewinde	L1 mm	L2 mm	SW mm
134441	MS251K1418	G 1/4	G 1/8	14,0	9,0	17
134442	MS251K3818	G 3/8	G 1/8	14,0	9,0	19
134443	MS251K3814	G 3/8	G 1/4	14,0	9,0	19
134444	MS251K1218	G 1/2	G 1/8	17,0	11,0	24
134445	MS251K1214	G 1/2	G 1/4	17,0	11,0	24
134446	MS251K1238	G 1/2	G 3/8	17,0	11,0	24
134447	MS251K3414	G 3/4	G 1/4	18,0	12,0	32
134448	MS251K3438	G 3/4	G 3/8	18,0	12,0	32
134449	MS251K3412	G 3/4	G 1/2	18,0	12,0	32
134450	MS251K1112	G 1	G 1/2	19,0	13,0	38
134451	MS251K134	G 1	G 3/4	19,0	13,0	38
134452	MS251K11434	G 1 1/4	G 3/4	21,0	14,0	50
134453	MS251K1141	G 1 1/4	G 1	21,0	14,0	50
134455	MS251K11234	G 1 1/2	G 3/4	23,0	15,0	55
134456	MS251K1121	G 1 1/2	G 1	23,0	15,0	55
134457	MS251K112114	G 1 1/2	G 1 1/4	23,0	15,0	55
134458	MS251K21	G 2	G 1	28,0	20,0	70
134459	MS251K2114	G 2	G 1 1/4	28,0	20,0	70
134460	MS251K2112	G 2	G 1 1/2	28,0	20,0	70
134461	MS251K212112	G 2 1/2	G 1 1/2	32,0	23,0	80
134462	MS251K2122	G 2 1/2	G 2	32,0	23,0	80
134463	MS251K31	G 3	G 1	36,0	26,0	95
134464	MS251K3114	G 3	G 1 1/4	36,0	26,0	95
134465	MS251K3112	G 3	G 1 1/2	36,0	26,0	95
134466	MS251K32	G 3	G 2	36,0	26,0	95
134467	MS251K3212	G 3	G 2 1/2	36,0	26,0	95



MS251K14M5

### Reduziernippel, kurze Ausführung

Artikel Nr.	Typen Nr.	Außengewinde	Innengewinde	L1 mm	L2 mm	SW mm
134468	MS251KM53	M5	M3	8,0	5,0	7
134469	MS251KM1410	M14x1,5	M10x1,0	14,0	9,0	17
134470	MS251KM2416	M24x1,5	M16x1,5	24,0	16,0	28
134471	MS251K18M5	G 1/8	M5	11,0	7,0	14
134472	MS251K14M5	G 1/4	M5	14,0	9,0	17



**NICHT DAS PASSENDE  
GEFUNDEN?**

Alle Produktvarianten, Dokumentation und weitere Informationen erhalten Sie auf Anfrage.