

## Reduziernippel

Messing vernickelt

**PLUS**

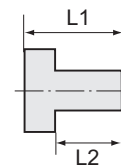

### Reduziernippel, Außengewinde konisch, Innengewinde zylindrisch

Artikel Nr.	Typen Nr.	Außengewinde	Innengewinde	Betriebs- temperatur max. °C	L1 mm	L2 mm	SW mm
111344	235.05/N	R 1/2	G 1/4	150	20,0	14,0	22
111345	235.06/N	R 1/2	G 3/8	150	20,0	14,0	22
111346	235.07/N	R 3/4	G 3/8	150	23,0	16,5	27
111347	235.08/N	R 3/4	G 1/2	150	23,0	16,5	27
111348	235.09/N	R 1	G 1/2	150	25,0	16,0	34
111349	235.10/N	R 1	G 3/4	150	25,0	18,0	34

## Doppelgewindenippel

Messing vernickelt

**PLUS**

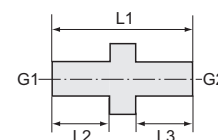

### Doppelgewindenippel, Außengewinde zylindrisch

Artikel Nr.	Typen Nr.	Gewinde 1	Gewinde 2	Betriebs- temperatur max. °C	L1 mm	L2 mm	L3 mm	SW mm
131891	MSN2521818	G 1/8	G 1/8	150	18,0	7,0	7,0	14
131892	MSN2521814	G 1/8	G 1/4	150	21,0	7,0	9,0	17
131893	MSN2521838	G 1/8	G 3/8	150	21,0	7,0	9,0	19
131894	MSN2521414	G 1/4	G 1/4	150	23,0	9,0	9,0	17
131895	MSN2521438	G 1/4	G 3/8	150	23,0	9,0	9,0	19
131896	MSN2521412	G 1/4	G 1/2	150	26,0	9,0	11,0	24
131897	MSN2523838	G 3/8	G 3/8	150	23,0	9,0	9,0	19
131898	MSN2523812	G 3/8	G 1/2	150	26,0	9,0	11,0	24
131899	MSN2523834	G 3/8	G 3/4	150	27,0	9,0	12,0	32
134283	MSN252381	G 3/8	G 1	150	28,0	9,0	13,0	38
131900	MSN2521212	G 1/2	G 1/2	150	28,0	11,0	11,0	24
131901	MSN2521234	G 1/2	G 3/4	150	29,0	11,0	12,0	32
131902	MSN252121	G 1/2	G 1	150	30,0	11,0	13,0	38
131904	MSN2523434	G 3/4	G 3/4	150	30,0	12,0	12,0	32
131903	MSN252341	G 3/4	G 1	150	31,0	12,0	13,0	38
131905	MSN25211	G 1	G 1	150	32,0	13,0	13,0	38
131906	MSN2521114	G 1	G 1 1/4	150	34,0	13,0	14,0	50
131907	MSN2521112	G 1	G 1 1/2	150	36,0	13,0	15,0	55
131908	MSN25212	G 1	G 2	150	41,0	13,0	20,0	70
134289	MSN25211412	G 1 1/4	G 1/2	150	32,0	14,0	11,0	50
134287	MSN25211434	G 1 1/4	G 3/4	150	33,0	14,0	12,0	50
131909	MSN252114114	G 1 1/4	G 1 1/4	150	35,0	14,0	14,0	50
131910	MSN252114112	G 1 1/4	G 1 1/2	150	37,0	14,0	15,0	55
131911	MSN2521142	G 1 1/4	G 2	150	42,0	14,0	20,0	70
134288	MSN25211234	G 1 1/2	G 3/4	150	34,0	15,0	12,0	50
131912	MSN252112112	G 1 1/2	G 1 1/2	150	38,0	15,0	15,0	55
131913	MSN2521122	G 1 1/2	G 2	150	43,0	15,0	20,0	70
131914	MSN25222	G 2	G 2	150	48,0	20,0	20,0	70
131915	MSN2522212	G 2	G 2 1/2	150	53,0	20,0	23,0	80
131916	MSN25223	G 2	G 3	150	57,0	20,0	26,0	95
131917	MSN252212212	G 2 1/2	G 2 1/2	150	56,0	23,0	23,0	80
131918	MSN2522123	G 2 1/2	G 3	150	60,0	23,0	26,0	95
131920	MSN25233	G 3	G 3	150	63,0	26,0	26,0	95



MSN2521818



**NICHT DAS PASSENDE  
GEFUNDEN?**

Alle Produktvarianten, Dokumentation und weitere Informationen erhalten Sie auf Anfrage.